

Mounting...

1. Locate the air intake opening beneath the center of the front bumper. Visible behind this is the front bumper cross brace just ahead of the radiator. This cross brace has several slots that face the front of the vehicle. The third slot from the passenger-side of the vehicle is located in the center of the vehicle and will be used as the mounting location for your siren bracket.
2. Using the four siren mounting bolts and washers, mount the siren box onto the bracket plate as shown in Fig. 1 below. *Be sure these bolts are firmly tightened.*
3. Position the bracket clamp so it straddles the center slot of the bumper cross brace (see Fig. 3).
4. Now position the siren box/bracket plate assembly in front of the bracket clamp. To accomplish this, it may be necessary to route the assembly up from the underside of the vehicle to a position in front of the cross brace on the passenger-side of the vehicle. From there, the assembly can be "snaked" around any obstacles until it is in position.
5. Insert the two bracket mounting bolts through the bracket plate and into the bracket clamp. Tighten these bolts firmly.
6. The two speaker wires coming from the siren box can now be connected to the vehicle's siren amplifier as outlined in the instructions included with the amplifier.



WARNING: For drainage purposes, both the speaker box's wire passage hole and the siren drivers weep hole must be located in the "6 o'clock" (closer to the road) position for proper mounting (See Fig. 2). Improper mounting will not only result in driver failure, but will also void the product warranty.

Fig. 1

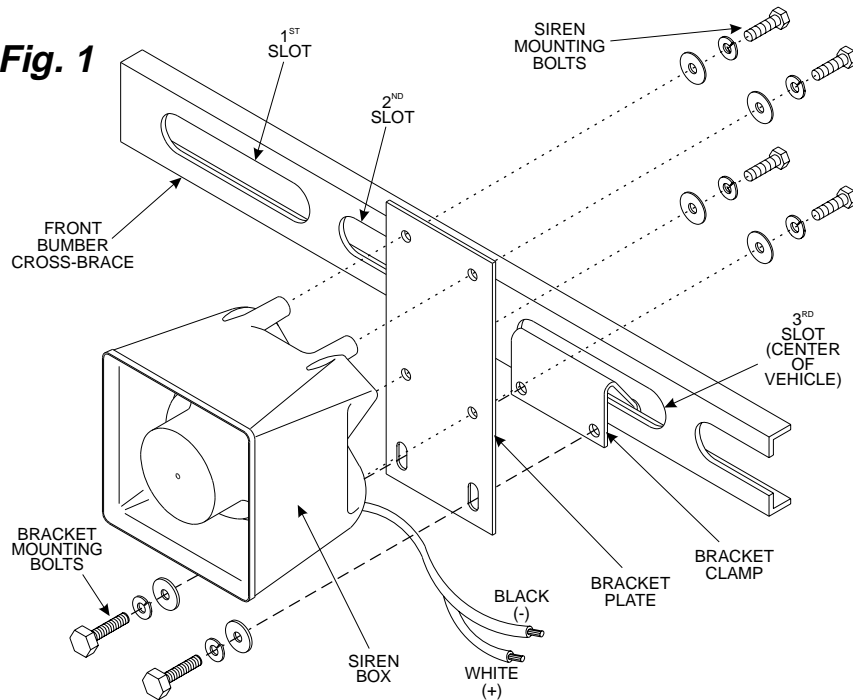

Fig. 2 (Rear View)

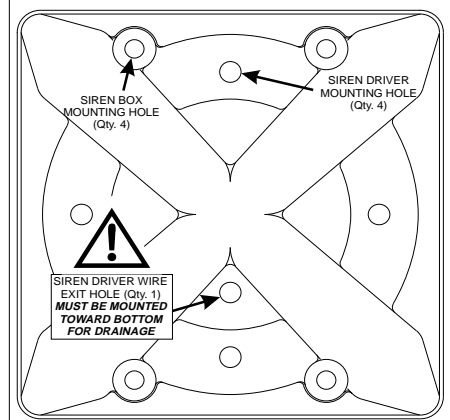
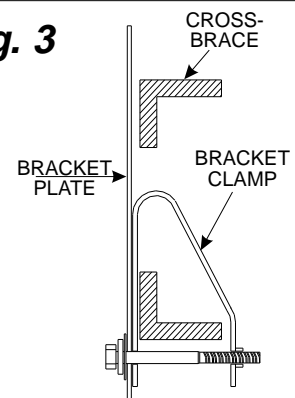

Fig. 3



Parts List For Kit BKGCV94

Qty	Description	Part Number
1	Bracket Plate	07-242087-000
1	Bracket Clamp	26-0142092-00
2	5/16" - 18 x 2" SS Hex Head Bolt	
2	5/16" SS Split Lockwasher	
2	5/16" SS Flat Washer	



CAUTION

Loud siren noise
 Can cause
 Hearing loss
 Minimize exposure
 Close windows when using

Mounting...

1. Locate the area where the front, passenger-side bumper strut meets the end of the passenger-side frame rail. This is the mounting location for your siren box.
2. Locate the bolt used to mount the front passenger-side bumper strut to the frame. Loosen the nut until it is flush with the end of the bolt and then unscrew it one additional turn. Do not remove the nut from the bolt (*see illustration*).
3. Using a hammer (or other suitable device) carefully "tap" the nut until there is a 1/2" clearance between the bolt head and the frame rail. **Note:** Do not remove this bolt from the frame! It is very difficult to replace.
4. Test fit the bracket so that it hangs from the loosened bolt. This will give you an idea of where the siren box will be located in relation to the vehicle. Now remove the bracket from the vehicle.
5. Because you will not be able to mount the bracket with the siren box attached, place the siren box in it's mounting area without the bracket.
6. Position the bracket as shown. Hang the bracket from the loosened bolt, making sure that the bracket is between the bolt head and the frame rail.
7. Mount the siren box tightly to the mounting bracket as shown below using the hardware supplied with the siren box.
8. Tighten the nut that was loosened in step #2 firmly.
9. Extend the WHITE (Positive) and BLACK (Negative) speaker wires to your siren amplifier and connect as outlined in the siren amplifier's instruction sheet.



WARNING: For drainage purposes, both the speaker box's wire passage hole and the siren drivers weep hole must be located in the "6 o'clock" (closer to the road) position for proper mounting (See Fig. 2). Improper mounting will not only result in driver failure, but will also void the product warranty.

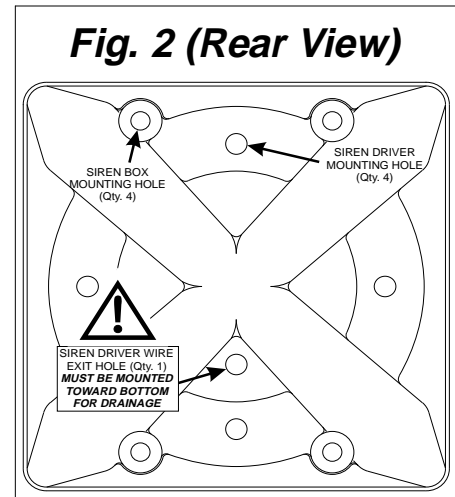
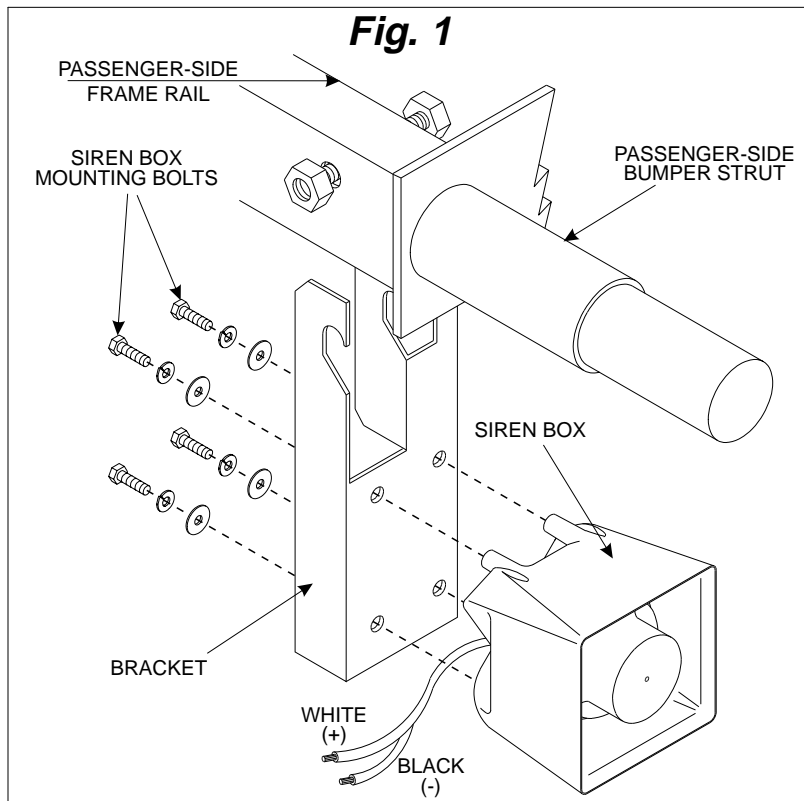

	CAUTION
	Loud siren noise Can cause Hearing loss Minimize exposure Close windows when using

Parts List For Kit BK GCV96

Qty	Description	Part No.
1	Bracket	BKG-CV96